

HINGE CUT OUT
NOT ACCOUNTED IN DIM.
VISUAL ONLY

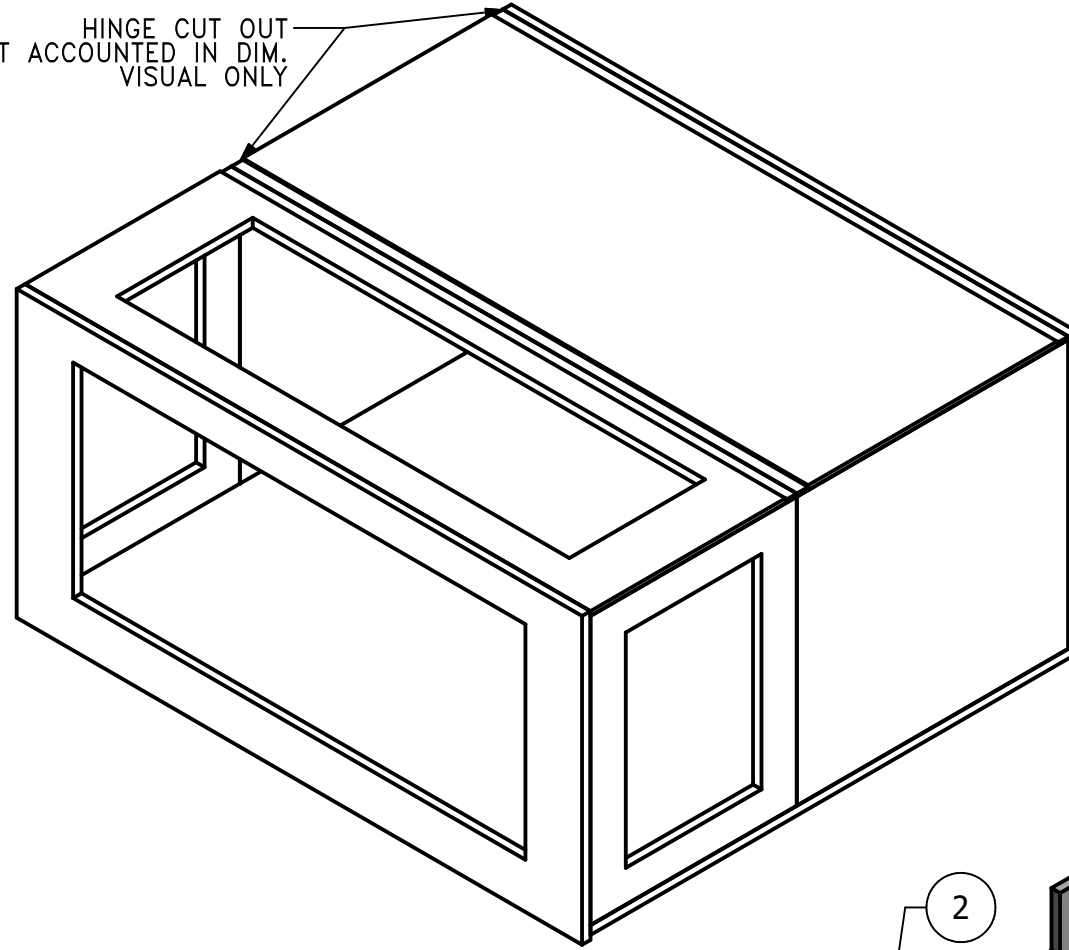

| PARTS LIST | | | |
|------------|-----|-------------|---------------|
| ITEM | QTY | PART NUMBER | SIZE |
| 1 | 1 | TOP_E_BASE | 50" x 43" |
| 2 | 1 | TOP_E_LID | PER DWG |
| 3 | 2 | TOP_E_SIDE | 23.625" x 24" |
| 4 | 1 | TOP_E_TOP | PER DWG |
| 5 | 1 | TOP_E_BACK | 24" x 50" |

